

STRAUB-GRIP-L-FIRE-FENCE Ø 26.9 - 219.1 mm

Components / Materials	W1	W2	W4	W5
Casing				AISI 316 L / 316 TI
Bolts				A4 - 80
U-Bars				AISI 316 L / 316 TI
Anchoring rings				AISI 301
Strip insert (option)				AISI 316 L / PVDF
Sealing sleeve EPDM	Temp.: -20°C up to +100°C	Medium: all qualities of water, waste water, air, solids and chemical products		
Sealing sleeve NBR	Temp.: -20°C up to +80°C	Medium: water, gas, oil, fuel and other hydrocarbons		
Sealing sleeve H-NBR (on request)	Temp.: -20°C up to +125°C	Medium: water, gas, oil, fuel and other hydrocarbons		
Sealing sleeve FPM / FKM	Temp.: -20°C up to +180°C	Medium: ozone, oxygen, acids, gas, oil and fuel (only with strip insert)		

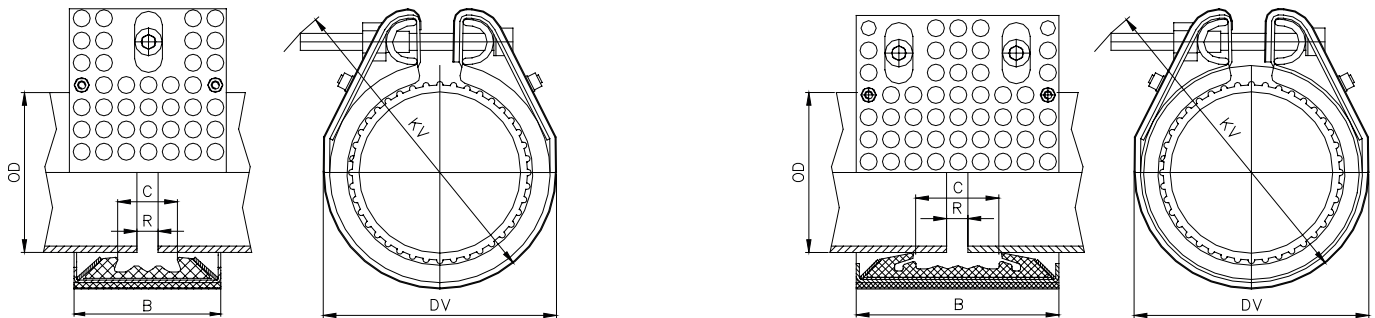

26.9 - 60.3 with single bolt

OD [mm]	Clamping range [mm]	PS [bar]	B [mm]	C [mm]	DV [mm]	KV [mm]	R without strip insert [mm]	R with strip insert [mm]	Torque rate [Nm]	Allen head [mm]	Thread M...
26.9	26.4 - 27.4	46.0	56	19	53	75	5	5	5	5	6
30.0	29.5 - 30.5	42.0	56	17	57	80	5	5	5	5	6
33.7	33.2 - 34.2	38.0	56	17	61	80	5	5	5	5	6
38.0	37.5 - 38.5	33.0	71	25	67	95	5	5-10	7.5	6	8
42.4	41.9 - 42.9	30.0	71	25	72	100	5	5-10	7.5	6	8
44.5	44.0 - 45.0	33.0	71	25	74	100	5	5-10	7.5	6	8
48.3	47.8 - 48.8	30.0	71	25	77	105	5	5-10	7.5	6	8
54.0	53.5 - 54.5	20.0	86	37	86	110	5-10	5-15	7.5	6	8
57.0	56.4 - 57.6	18.0	86	37	86	110	5-10	5-15	10	6	8
60.3	59.7 - 60.9	22.0	86	37	89	115	5-10	5-15	7.5	6	8
66.6	64.9 - 67.3	34.0	111	35	97	131	5-10	5-20	10	6	8
70.0	68.9 - 70.7	32.0	111	36	102	136	5-10	5-20	10	6	8
73.0	72.3 - 73.7	31.0	111	41	106	147	5-10	5-25	12	6	8
76.1	75.3 - 76.9	31.0	111	41	108	147	5-10	5-25	12	6	8
79.5	78.7 - 80.3	28.0	111	35	110	147	5-10	5-25	12	6	8
84.0	83.2 - 84.8	26.0	111	35	122	157	5-10	5-25	12	6	8
88.9	88.0 - 89.8	22.0	111	41	121	162	5-10	5-25	12	6	8
100.6	99.6 - 101.6	22.0	111	35	139	177	5-10	5-25	12	6	8
101.6	100.6 - 102.6	22.0	111	35	140	177	5-10	5-25	15	6	8
104.0	103.0 - 105.0	22.0	111	35	142	177	5-10	5-25	12	6	8
104.8	103.8 - 105.8	22.0	111	35	143	177	5-10	5-25	12	6	8
108.0	106.9 - 109.1	21.0	111	41	140	177	5-10	5-25	12	6	8
114.3	113.2 - 115.4	16.0	111	41	146	182	5-10	5-25	12	6	8
127.0	125.7 - 128.3	19.0	126	54	161	200	5-10	5-30	20	8	10
129.0	127.7 - 130.3	19.0	126	54	163	200	5-10	5-30	20	8	10
130.2	128.9 - 131.5	19.0	126	54	164	205	5-10	5-30	20	8	10
133.0	131.7 - 134.3	19.0	126	54	167	205	5-10	5-30	20	8	10
139.7	138.3 - 141.1	16.0	126	54	174	215	5-10	5-30	20	8	10
141.3	139.9 - 142.7	16.0	126	54	176	215	5-10	5-30	20	8	10
154.0	152.5 - 155.5	16.0	126	48	194	230	5-10	5-30	20	8	10
159.0	157.4 - 160.6	16.0	126	54	193	230	5-10	5-30	20	8	10
168.3	166.6 - 170.0	16.0	126	54	202	235	5-10	5-30	20	8	10
219.1	216.9 - 221.3	16.0	158	80	260	300	5-10	5-30	60	10	12

Remarks:

- Follow fitting / disassembly instructions
- PS = Working pressure considering the application loads
Test pressure = PS x 1.5 (for example industry, water supply etc.)
- The pressure values are valid on radial rigid carbon steel pipes under static loads
- For minimum wall-thickness of pipe, see technical manual
- Strip inserts are required for special applications

For IPS sizes in bold see technical manual for actual OD

Typing errors may occur. Technical details are subject to change

Marine Ventures Ltd, Marven House, 1 Field Road, Reading, RG1 6AP

Tel: +44 (0)118 9503707 - Fax: +44 (0)118 9504066 - info@straub.co.uk - www.straub.co.uk

STRAUB-GRIP-L-FIRE-FENCE Ø 180.0 - 406.4 mm

Components / Materials	W1	W2	W4	W5
Casing		AISI 316 L / 316 TI		AISI 316 L / 316 TI
Bolts		AISI 4135		A4 - 80
Bars		AISI 12 L 14, galvanised		AISI 316 L / 316 TI
Anchoring rings		AISI 301		AISI 301
Strip insert (option)		AISI 316 L / HDPE		AISI 316 L / HDPE
Sealing sleeve EPDM	Temp.: -20°C up to +100°C Medium: all qualities of water, waste water, air, solids and chemical products			
Sealing sleeve NBR	Temp.: -20°C up to +80°C Medium: water, gas, oil, fuel and other hydrocarbons			
Sealing sleeve FPM / FKM	Temp.: -20°C up to +180°C Medium: ozone, oxygen, acids, gas, oil and fuel (only with strip insert)			

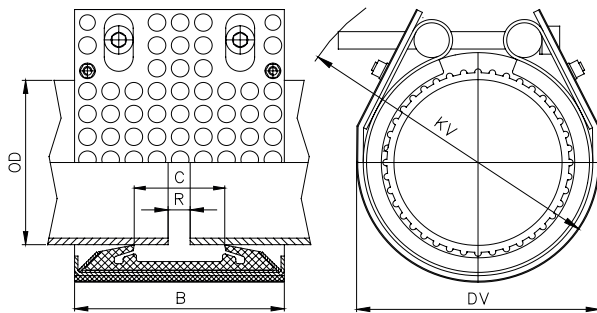

OD [mm]	Clamping range [mm]	PS [bar]	B [mm]	C [mm]	DV [mm]	KV [mm]	R without strip insert [mm]	R with strip insert [mm]	Torque rate [Nm]	Allen head [mm]	Thread M...
180.0	178.0 - 182.0	16.0	158	80	260	275	5-10	5-35	50	10	12
193.7	192.0 - 195.5	16.0	158	80	275	290	5-10	5-35	50	10	12
200.0	198.0 - 202.0	15.0	158	80	280	295	5-10	5-35	50	10	12
204.0	202.0 - 206.0	14.0	158	80	285	300	5-10	5-35	50	10	12
206.0	204.0 - 208.0	14.0	158	80	234	280	5-10	5-35	50	10	12
244.5	242.0 - 247.0	9.0	158	80	325	340	5-10	5-35	50	10	12
250.0	247.5 - 252.5	9.0	158	80	330	345	5-10	5-35	50	10	12
254.0	251.5 - 256.5	9.0	158	80	330	345	5-10	5-35	50	10	12
256.0	253.5 - 258.5	9.0	158	80	284	325	5-10	5-35	50	10	12
267.0	264.5 - 269.5	8.0	158	80	345	360	5-10	5-35	50	10	12
273.0	270.5 - 275.5	7.0	158	80	350	365	5-10	5-35	60	10	12
304.0	301.0 - 307.0	6.0	158	80	380	395	5-10	5-35	60	10	12
306.0	303.0 - 309.0	6.0	158	80	334	375	5-10	5-35	60	10	12
323.9	320.5 - 327.0	5.0	158	80	400	415	5-10	5-35	60	10	12
355.6	352.0 - 359.0	4.0	158	80	430	445	5-10	5-35	60	10	12
406.4	402.5 - 410.5	3.0	158	80	475	490	5-10	5-35	60	10	12

Remarks:

- Follow fitting / disassembly instructions
- PS = Working pressure considering the application loads
Test pressure = PS x 1.5 (for example industry, water supply etc.)
- The pressure values are valid on radial rigid carbon steel pipes under static loads
- For minimum wall-thickness of pipe, see technical manual
- Strip inserts are required for special applications

For IPS sizes in bold see technical manual for actual OD

Typing errors may occur. Technical details are subject to change